

The background features a large, vibrant green circle in the center containing the word "pearl" in white lowercase letters and "SHOWROOM" in white uppercase letters below it. The green circle is framed by two light blue curved lines. The entire scene is set against a white background with abstract dark blue shapes, including a large curved shape on the left and a circular shape on the right. Several smaller circles in green and blue, some with gradients, are scattered around. Thin, dark blue wavy lines also traverse the background.

pearl

SHOWROOM

PURE
CASINO
YELLOWHEAD

turning on the LED wall

LED Wall is controlled through a rack mounted unit in the back area in the warehouse.

To turn on the wall you will need to hit the power switch on the back of the controller.

(Our team will turn this on for you; if it is not on please check in with on-site contact.)



adjusting LED wall brightness

To adjust LED wall brightness you will need to turn on the VSP-F2L4

Once the system is on press the SET UP button.

You will see a PRODUCT, IP ADDRESS, DATA SAVE selection. Make sure the arrow is on PRODUCT

(You typically will NOT need to adjust brightness as programing is optimized already.)



adjusting LED wall brightness

With the arrow on BRIGHT press the SEL button

Use the dial on the front of the VSP=F2L4 and turn it counter clockwise until the dial reads BRIGHT 10, then press the SEL button again.

Press the ESC button 4 times to escape back to the main menu.



selecting inputs to the LED wall

On top of the rack located in front of the Green Room there is black box with an orange V shaped stripe on it labeled **ATLONA**.

On the front of the ATLONA box there are 4 buttons which correspond to the inputs on the back. By default the #1 input will be the Bell 7 receiver in the back , additional inputs may include the House Computer or any other HDMI Cables that are connected to the box.



selecting inputs to the LED wall

Press the button of the input you would like to send to the LED Wall. If you are not seeing the display check the connection on the back of the box and on the source.

Please note that with computers sometimes you will need to work with the display settings to make sure it is displaying properly on the TV. These settings are unique to each device but the resolution should be around 1920x1080, the VSP-F2L4 Rack in the back will process the signal and scale it to the adequate size.



turning on house computer

In house we are running a PC Laptop which has Spotify, and is duplicated to the LED Screen.

To access the computer you will need to turn it on. Password is: Winter2023

If the screen is not duplicated, please ensure the settings are correct but Right Clicking on Desktop and selecting Display Settings.

Ensure **DUPLICATE THESE DISPLAYS** is selected.

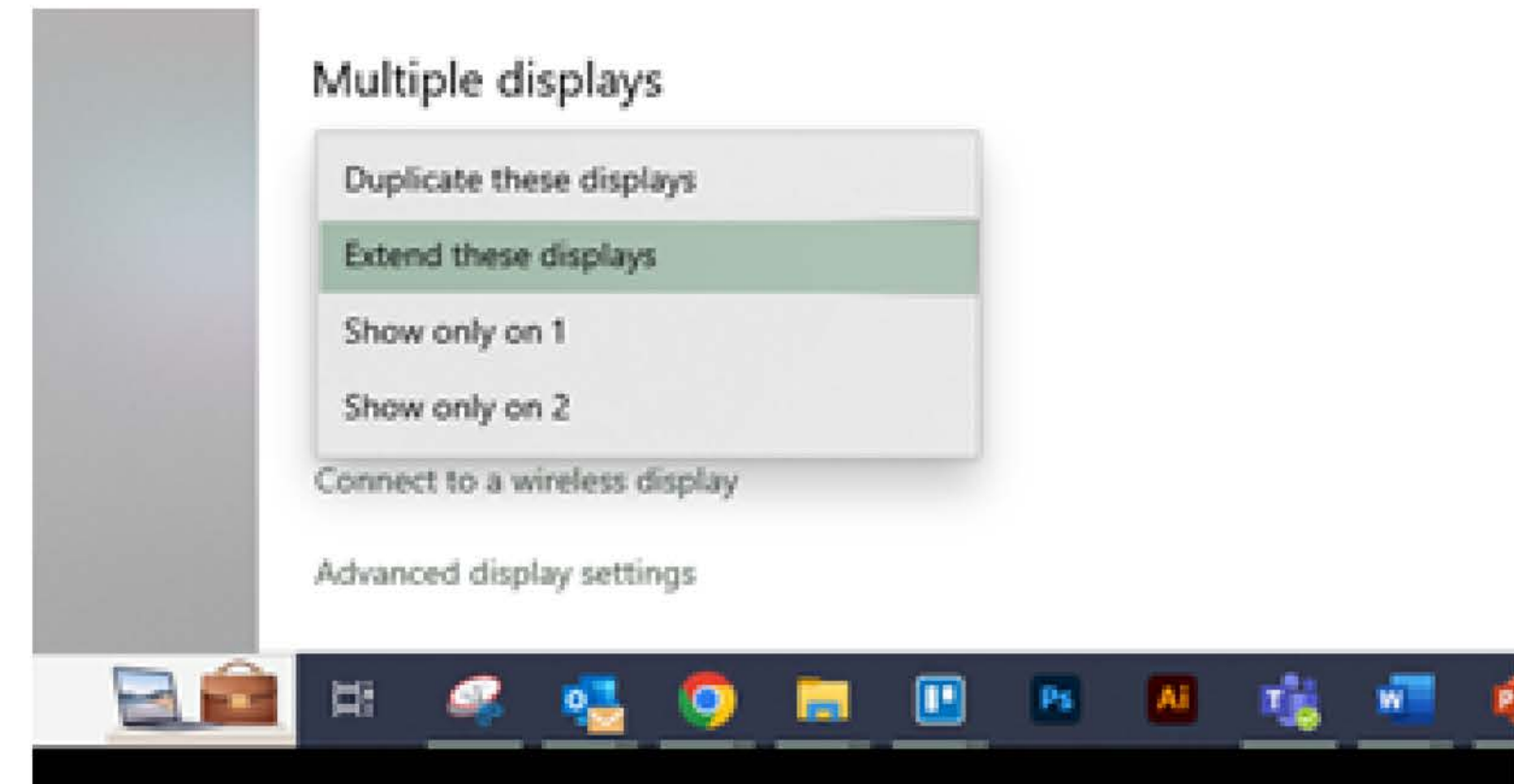

turning on house computer

Anything that shows on the computer screen will show on the LED Screen.

LED Screen can show video or images. Ensure you bring all elements on an external hard drive or USB stick; along with any cue sheets needed to ensure a smooth running show.

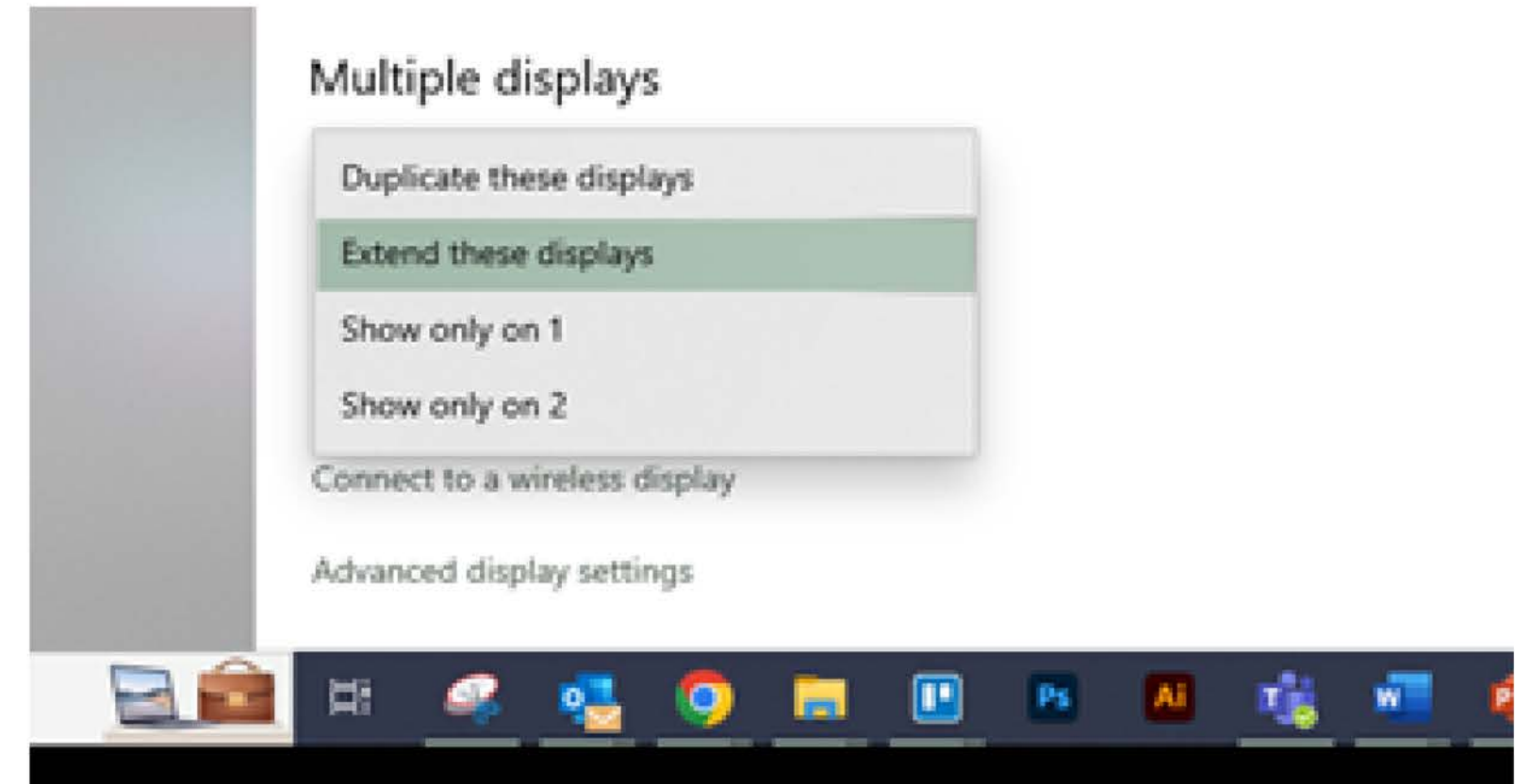

turning on house sound

For In-House Music, access SPOTIFY via LED/HOUSE Computer.

Pre-populated playlists are available of various genres.

Check to make sure the computer is not muted and that the tracks are playing.

This should now be sending sound to the X-32 controller which you can control via iPad.

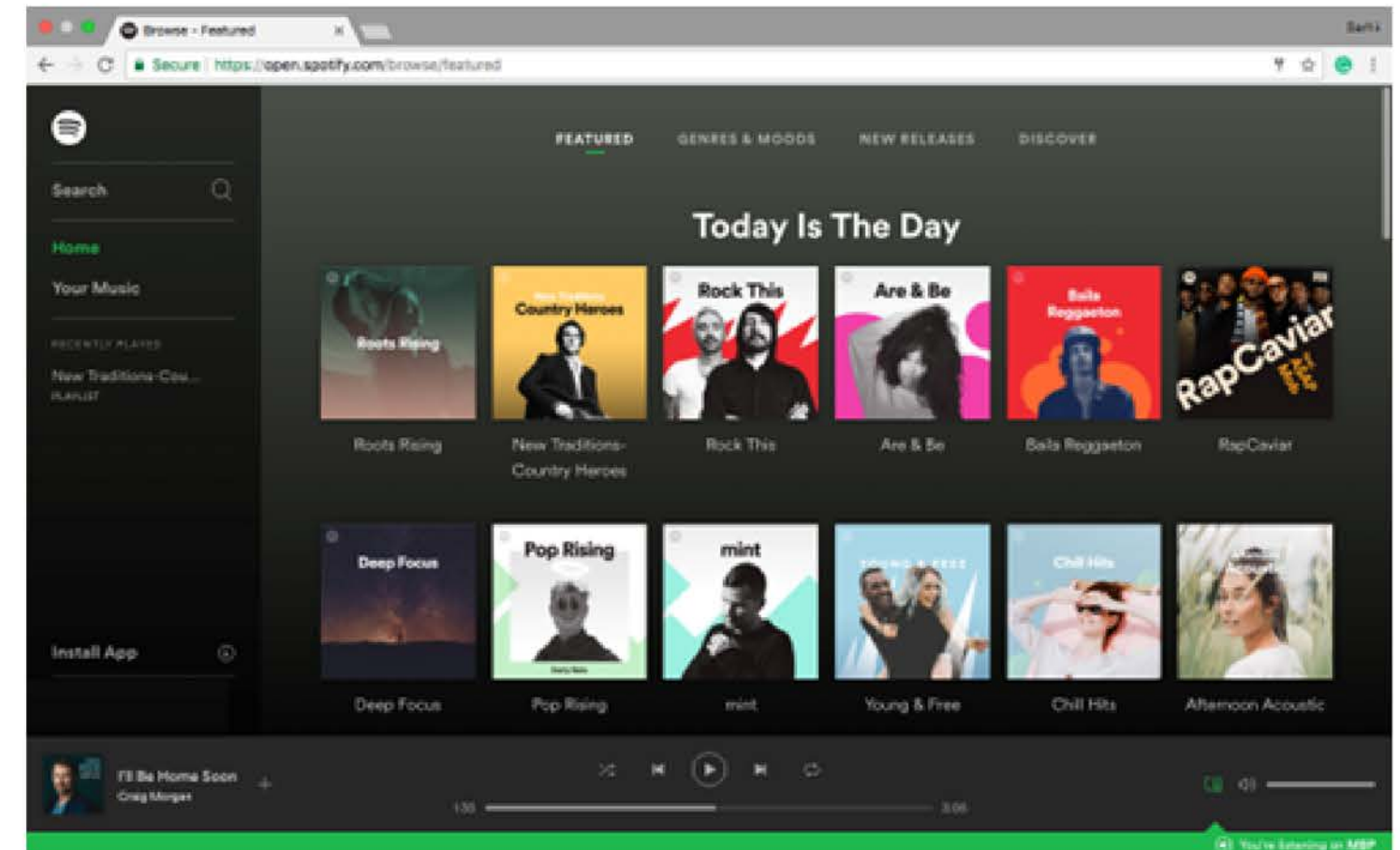

controlling music, mics & more

iPad will show a connection screen.

If all the numbers are in green continue on, if not you will need to connect the system to the wireless network.

Once you are connected to the X-32 on the iPad.

Go to the top menu bar and select **ROUTING**.

This is the 3rd icon from the right.



controlling music, mics & more

This will open a new screen. On that screen select PRESET and load the PEARL PRESET 1 pre-set.

This will open a new screen. On that screen select PRESET and load the PEARL PRESET 1 pre-set.

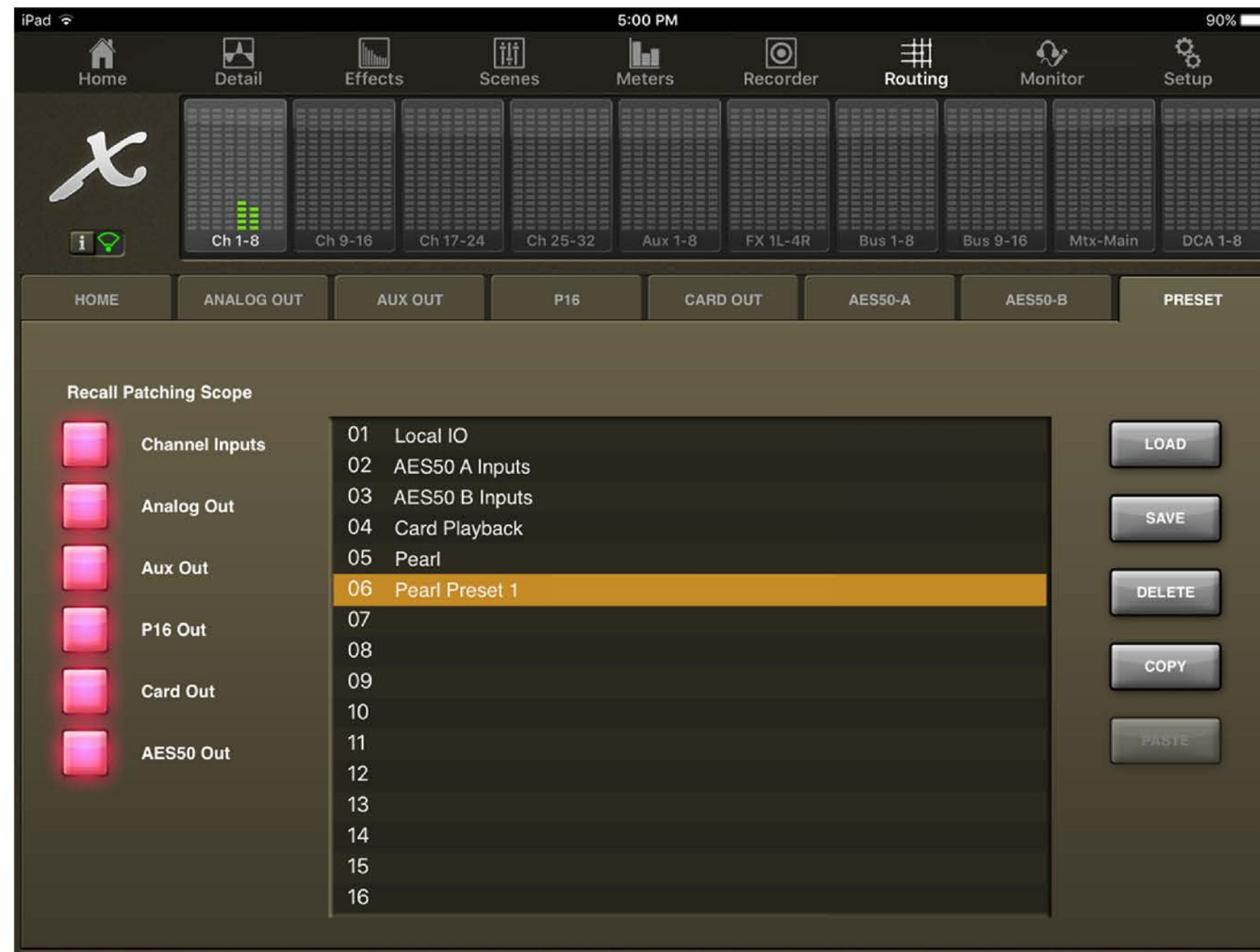

controlling music, mics & more

This will reconfigure the connections and allow you to plug up to 4 input into the back snake, run sound from the computer and run 2 wireless mics.

To run sound from the computer select the HOME button on the main screen.

Under input 5+6 there are 2 pink sliders, raise or lower these to raise or lower the volume.

If you see the VU meter moving, raise the slider to the desired level. If you are still not hearing anything make sure that you have not muted the channels.

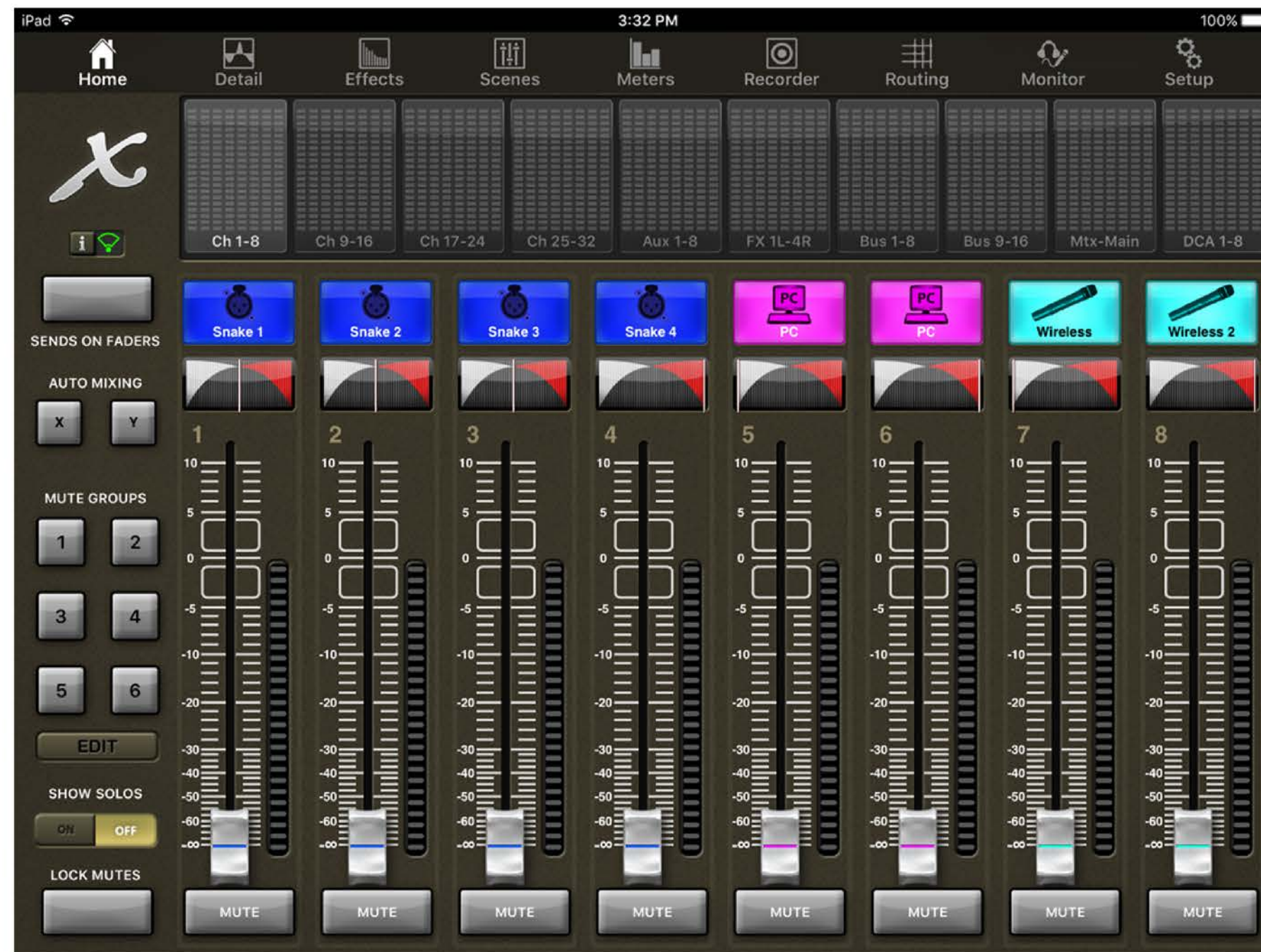

controlling music, mics & more

A muted channel will have the word **MUTE** in box in the bottom of the screen.

If the channels are muted **DROP** the volume **BEFORE** unmuting the channels. Once the channels are unmuted raise the slider. If you are still not getting sound you will need to check the **MAIN Sends**.

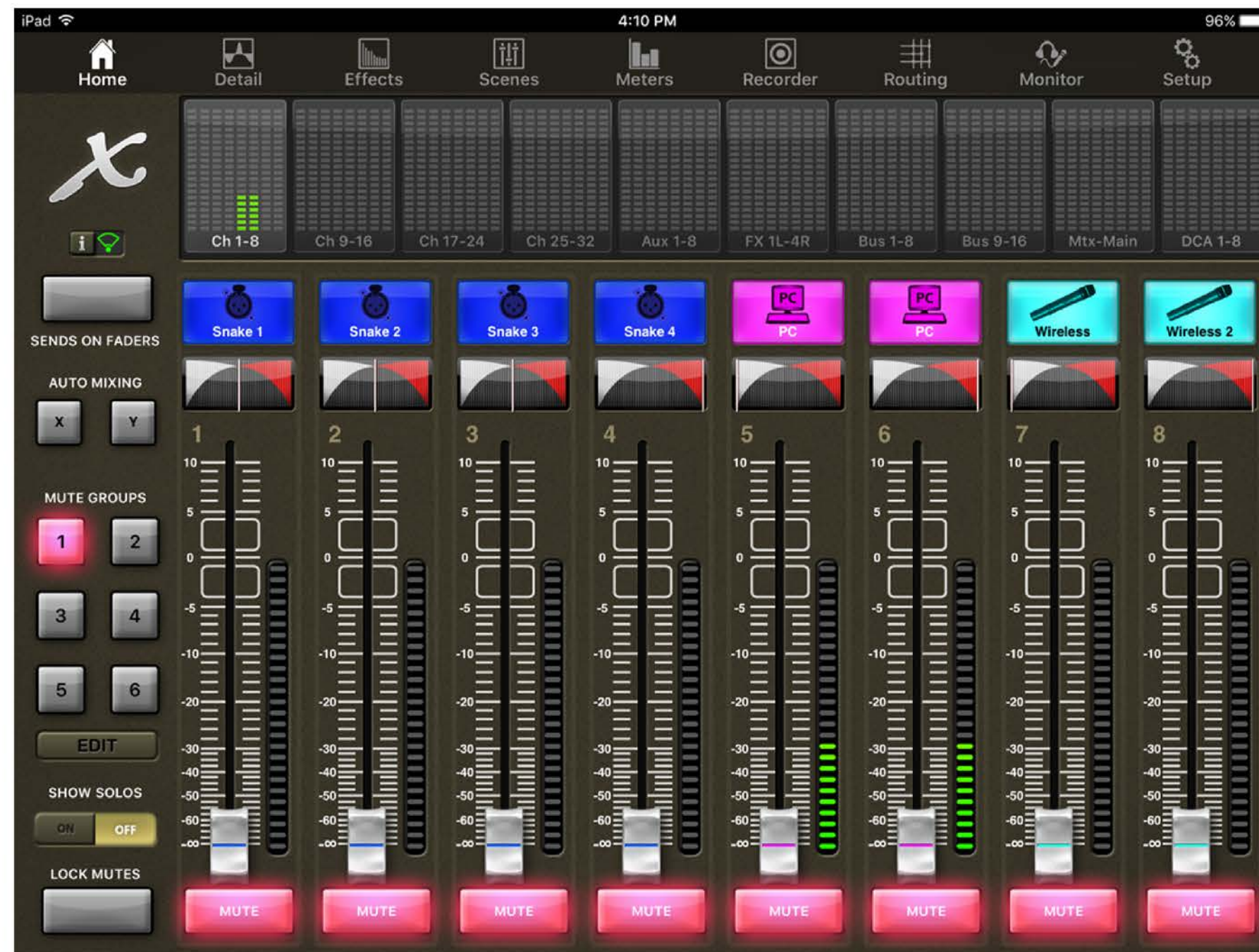



controlling music, mics & more

To check the main sends select the MTX-MAIN button this button will highlight open up a screen which will show the different outputs.

Channel 1 and 2 are the main speakers.

Channel 3 and 4 are the Subwoofers (bass cabinets)

Channels 5 and 6 are the sidefills (stage speakers)

MAIN/MASTER slider controls the over all volume.

Make sure these aren't muted and that they are at an adequate level. These too should have the VU meters moving about showing that they have signal going to them. If you are not seeing them VU meters move, or they are moving but no sound is coming out there may be a more serious routing issue.

Please call a tech - This may result in an invoiced charge.

connecting mics to stage snake

A stage snake is a large rectangular box that has several input and outputs on it.

There are 2 snakes a front of house snake and a back of house snake. For this exercise we will be dealing only with the back of house snake.

The back of house snake is located at the back of the stage and is labeled as 1-12 with 4 outputs.

To plug in a microphone, grab the wired mic and an xlr cable. Plug one end into the microphone and another into the snake. Where you plug the microphone is in important as that will be the INPUT that you will see on the iPad. Start with number 1 and work your way down from there.



connecting mics to stage snake

Please note that microphones are not preamp'd; while DJ Controllers and mixers are.

Volume levels have been set on channels 1-4 at Mic Levels.

If you are plugging anything in other than a microphone you will need to adjust the gain/attenuation of the channel.

To adjust the gain of the channel, click on the channel you want to adjust by selecting the coloured box. From there you will see a gain knob. Hold the gain knob down and slide your finger up to turn the gain up or down to turn it down.



controlling the lights - connection

The lights are controlled through a silver box that talks to the lights and the computer. This silver box is called a lighting dongle. This dongle needs to be connected to the grey Dell laptop with a USB to properly communicate with the lights.

The lighting controller computer also need to be connected to the wireless routers in order to talk to the iPad.

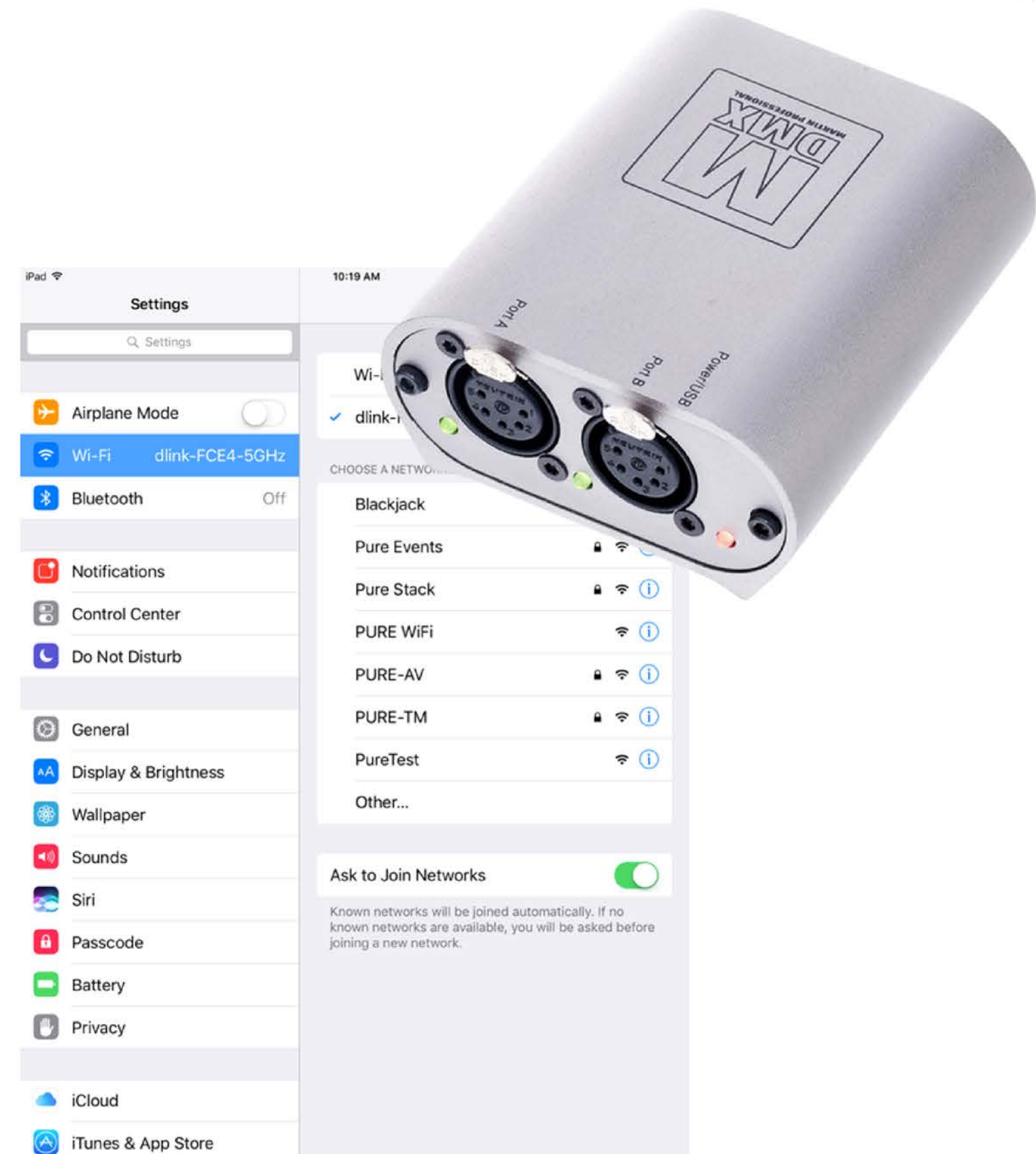

controlling the lights - connection

The Wireless network that the iPad and the lighting controller computer are on is Dlink-FCE4-5GHz.

You must be connected to this network on BOTH the iPad and the Laptop for the controller to work.

The password to the router is:
atlqd47306

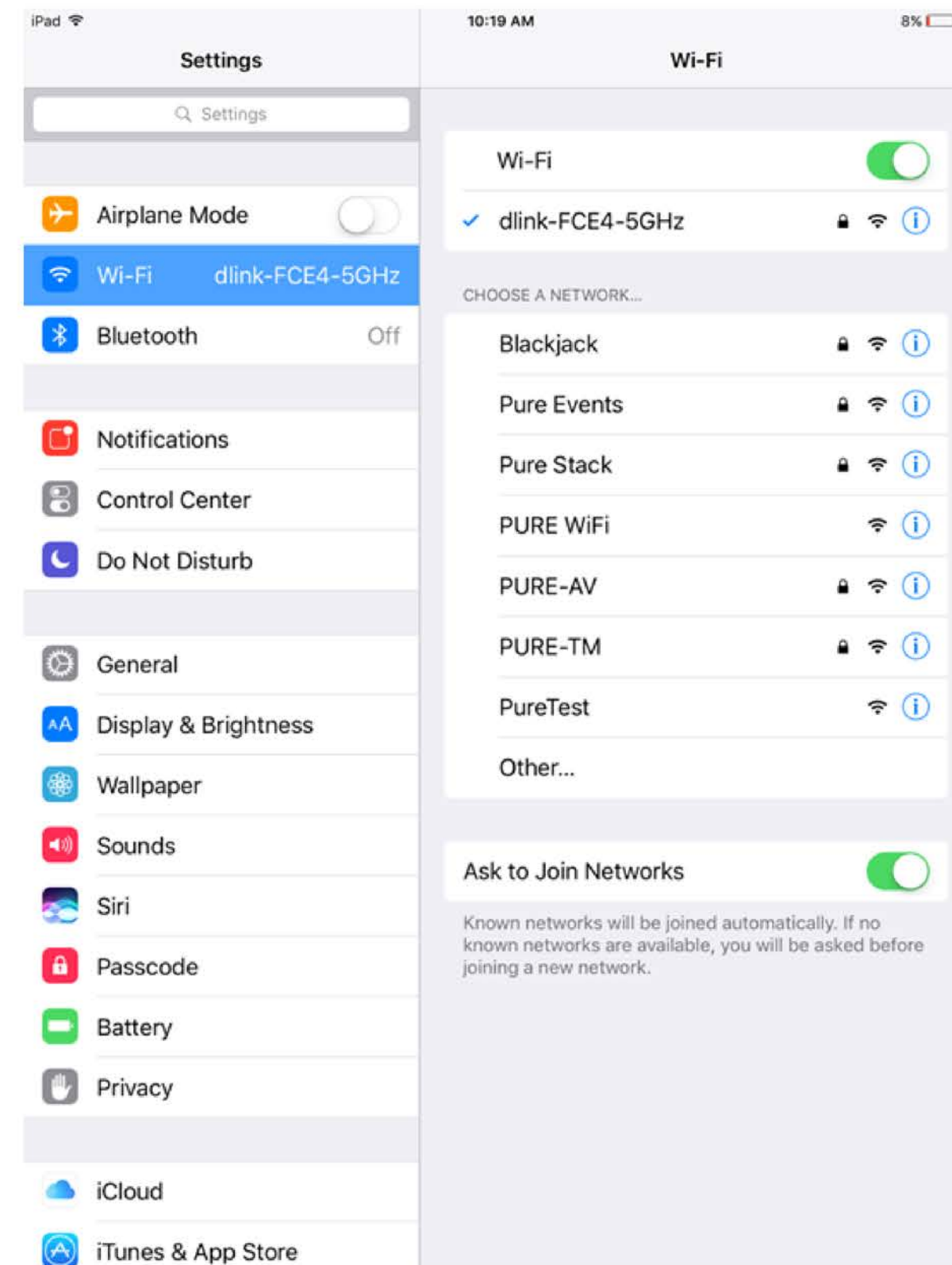

controlling the lights - ipad

To control the lights using the iPad you will need to select M-Series from the icon menu.

Once you select that it should connect to the network and the lighting computer. If it does not check your wifi connection and make sure it is on the Dlink-FCE4-5GHz network.



controlling the lights - ipad

Once you have connected to the program select **PAGE 2** from the **PLAYBACK PAGES**

You will see several scenes. To activate a scene make sure that the **GO** button at the top of the page is highlighted in blue then select the scenes you would like to use.

You can stack multiple scenes on top of each others and some, like moderate chaos and higher chaos, have multiple settings within the scenes that can be activated by clicking the scene multiple times.

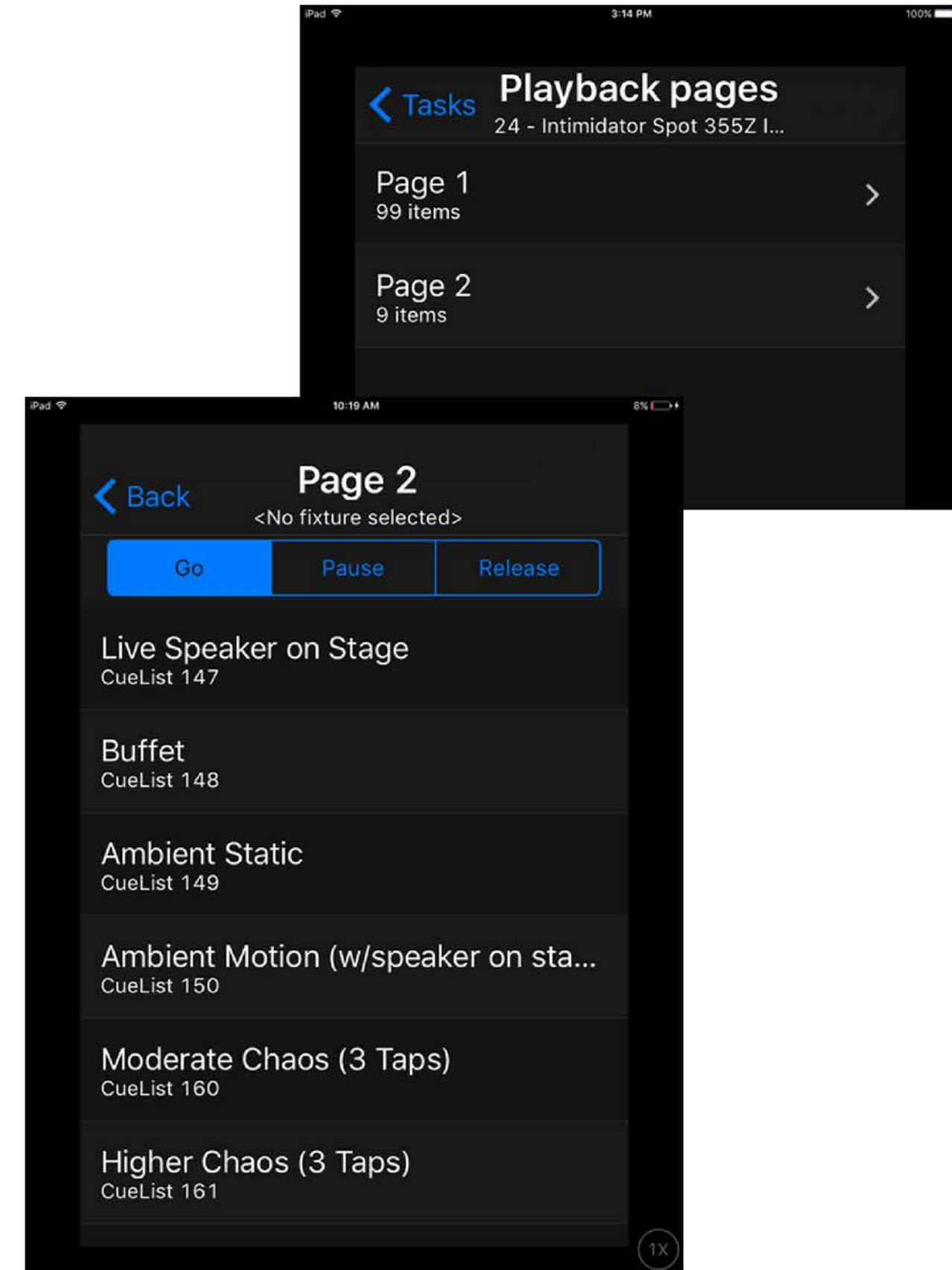

controlling the lights - ipad

To release the scenes click on the RELEASE button until it is highlighted blue then select the scenes you would like to release.

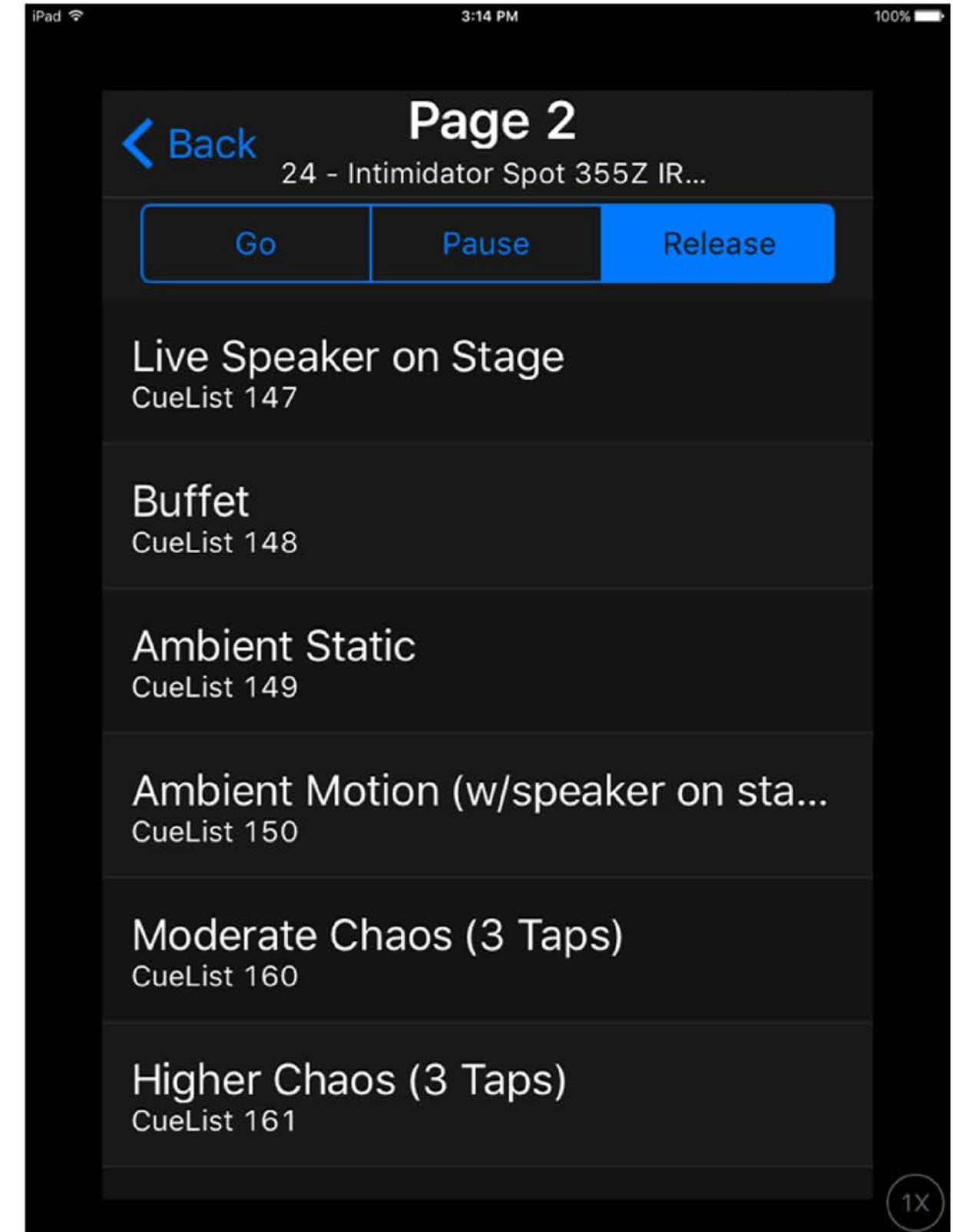



emergency contact

If you have issues with equipment, a tech should be able to help.

However, this may result in a charge being invoiced to you.

If you are unsure of how to use equipment, it is strongly encouraged you book a tech person to run your show through us. Cost varies, but is typically around \$500 (but this will ensure your event runs smoothly).



BILL HANSON
780-991-2418



LACEY SLATER
780-699-2925